



Supplies needed

- Suction canister
- Suction tubing

Directions

Prior to use

- Perform a skin assessment and document per hospital protocol.
- Refer to manufacturer's instructions for suction set up.
- Ensure patient meets hospital protocol prior to placing device.

Placement

- Step 1** Set up suction canister and tubing according to hospital protocol. Replace tubing and empty and/or replace suction canister per hospital protocol.
- Step 2** Place patient in supine position and separate patient's legs.
- Step 3** Clean, prep, and dry patient's genital area from front to back, per hospital protocol and assess skin integrity.
- Step 4** Remove device from package.
- Step 5** Attach suction tubing to the device at the suction tubing adapter.
 - Ensure connection of suction tubing to device is secure and connected at all times while the device is in use.
 - Confirm there are no kinks in the tubing and that tubing does not run under the patient.
- Step 6** Position device vertically with tapered end facing downward and fabric facing patient's labia.
- Step 7** Align tapered end with perineum and place device between the labia and against the urethral opening. Ensure fabric is covering the urethral meatus. If used on retracted male anatomy, use clinical judgment and hospital protocol.
- Step 8** Curve the device toward the patient's lower abdomen.
- Step 9** While holding the device in place, remove the adhesive liner and adhere the adhesive pad over the suprapubic region.
- Step 10** Ensure suction tubing does not run under the patient. Secure tubing per hospital protocol.
 - Ensure adequate length of suction tubing is available.
- Step 11** Set vacuum to low, continuous suction at a minimum of 60 mmHg. Always use the minimum amount of suction necessary.
- Step 12** Return patient's legs to naturally closed position and raise bed to comfortable position. Assess device periodically to ensure proper placement, particularly after turning or repositioning patient.
 - Replace device every 12-24 hours, or if soiled with stool or bodily fluids other than urine. Dispose of device per hospital protocol and local regulations.

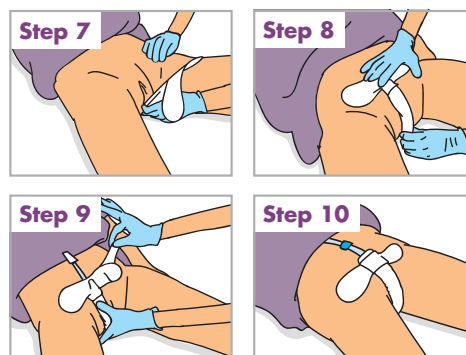

Removal

- Step 1** Place the patient in the supine position and separate patient's legs.
- Step 2** Gently remove the adhesive pad.
- Step 3** Separate the labia and remove the device.
- Step 4** Assess skin integrity and perform perineal care.
- Step 5** Disconnect device from suction tubing and discard device per hospital protocol and local regulations.

Discontinue use

- When independent or assisted toileting is feasible.
- During patient ambulation.

Indications

For the non-invasive external collection of urine for adolescent through adult patients with female anatomy who require urine management

Contraindications

- Do not use on patients with urinary retention

Warning

- Do not place internally

Cautions

- Not intended for use on patients in the prone position
- Not intended for use on patients with the non-retracted male anatomy
- Not intended for stool collection
- Use caution if using on patients with altered mental status

40 devices/case **Reorder #5400**

- Single use only
- Not made with natural rubber latex
- Non-sterile